

Property lines are approximate

352 ARIZONA LANE
HUNTSVILLE, TEXAS | 4.26 +/- ACRES



352 ARIZONA LANE



Discover the perfect blend of privacy and convenience with this 4.26-acre parcel located just minutes north of Huntsville. Partially cleared and ready for your dream home, this property features a well and a prime homesite already in place. The land is partially wooded, offering a serene, rural feel while still providing quick access to town for shopping, dining, and everyday essentials. Whether you're looking to build now or invest for the future, this is an ideal opportunity to own a spacious piece of land in a desirable location.



Markham Realty
Selling Quality Texas Properties Since 1970
contact@markhamrealty.com
936-295-5989 | markhamrealty.com



Scan here for additional
information & photos.



Information furnished is from sources deemed reliable, but is not guaranteed by Markham Realty, Inc. The offerings are subject to change in price, errors, omissions, prior sales, or withdrawal without notice. Square footage, acreage size and lot dimensions are approximate. All persons and firms named in this brochure are licensed brokers or salespersons. Markham Realty, Inc. will co-broker with any licensed Broker if Broker and/or agent accompanies his or her prospective buyer from the first (1st) showing forward.

352 ARIZONA LANE HUNTSVILLE, TEXAS

**Markham
Realty**

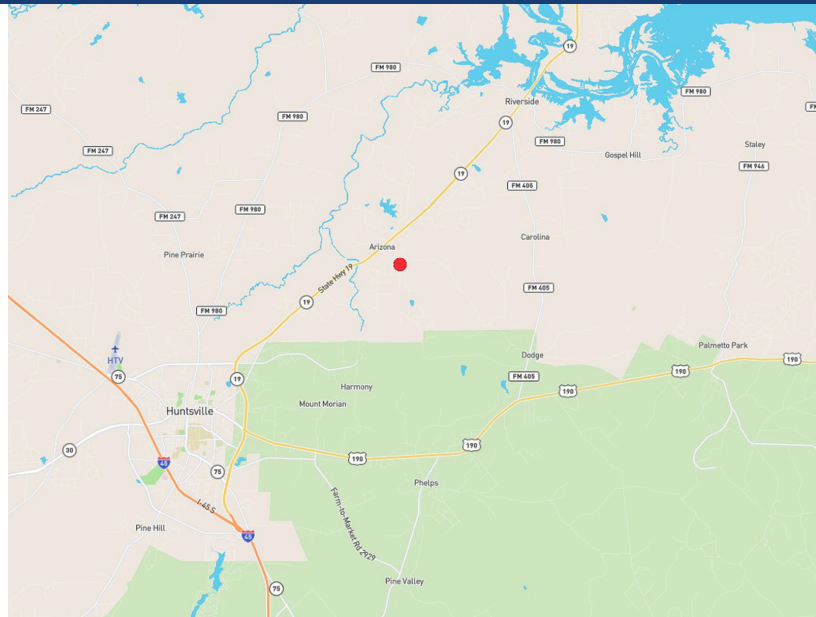
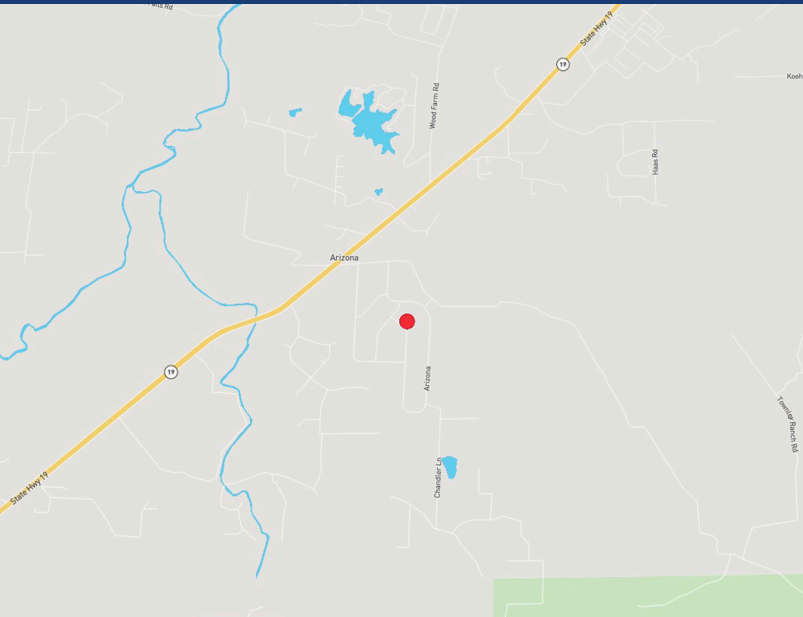

Directions: From Huntsville, take Hwy 19 north. Turn left onto Sterling Chapel. Turn right onto Arizona. Turn right onto N Fork. Turn left onto Arizona Lane. Property will be on your left.



**Markham
Realty**

Markham Realty
Selling Quality Texas Properties Since 1970
contact@markhamrealty.com
936-295-5989 | markhamrealty.com



Scan here for additional
information & photos.



Information furnished is from sources deemed reliable, but is not guaranteed by Markham Realty, Inc. The offerings are subject to change in price, errors, omissions, prior sales, or withdrawal without notice. Square footage, acreage size and lot dimensions are approximate. All persons and firms named in this brochure are licensed brokers or salespersons. Markham Realty, Inc. will co-broker with any licensed Broker if Broker and/or agent accompanies his or her prospective buyer from the first (1st) showing forward.